

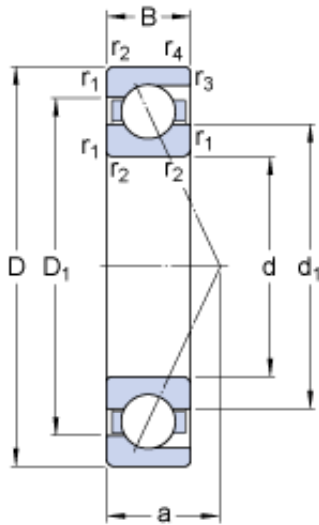

BEARING USA CORP.



70/600 AGMB Bearing 2D drawings and 3D CAD models

600 mm x 870 mm x 118 mm SKF 70/600 AGMB Angular contact ball bearings

Bearing No. 70/600 AGMB

Size	870x600x118 mm
Bore Diameter	870 mm
Outer Diameter	600 mm
Width	118 mm
d	600 mm
D	870 mm
B	118 mm
d ₁	693 mm
D ₁	779.4 mm
a	273 mm
r _{1,2} - min.	6 mm
r _{3,4} - min.	3 mm
d _a - min.	623 mm
D _a - max.	847 mm
D _b - max.	857 mm
r _a - max.	5 mm
r _b - max.	2.5 mm
Basic dynamic load rating - C	884 kN
Basic static load rating - C ₀	2160 kN
Fatigue load limit - P _u	34 kN
Reference speed	700 r/min
Limiting speed	750 r/min
Calculation factor - k _r	0.085
Calculation factor - k _a	0.5



BEARING USA CORP.

Calculation factor - e	0.8
Calculation factor - X	0.63
Calculation factor - Y_0	0.66
Calculation factor - Y_1	0.78
Calculation factor - Y_2	1.24
Calculation factor - X	0.39
Calculation factor - Y_0	0.33
Calculation factor - Y_1	
Calculation factor - Y_2	0.76
d_1	693 mm
D_1	779.4 mm
$r_{1,2}$ min.	6 mm
$r_{3,4}$ min.	3 mm
d_a min.	623 mm
D_a max.	847 mm
D_b max.	857 mm
r_a max.	5 mm
r_b max.	2.5 mm
Basic dynamic load rating C	884 kN
Basic static load rating C_0	2160 kN
Fatigue load limit P_u	34 kN
Calculation factor A	35.7
Calculation factor k_r	0.085
Calculation factor e	0.8
Calculation factor X	0.39
Calculation factor Y_0	0.33
Calculation factor Y_2	0.76
Calculation factor X	0.63
Calculation factor Y_0	0.66
Calculation factor Y_1	0.78
Calculation factor Y_2	1.24



BEARING USA CORP.

Mass bearing	236 kg
--------------	--------