

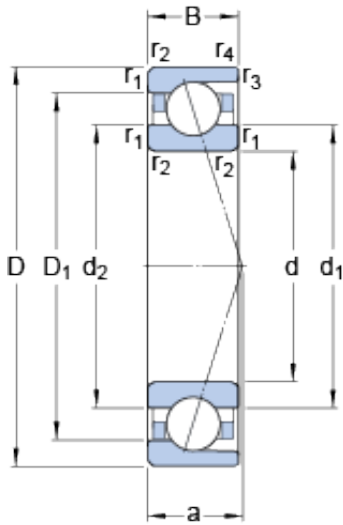

BEARING USA CORP.



7222 ACD/P4A Bearing 2D drawings and 3D CAD models

110 mm x 200 mm x 38 mm SKF 7222
ACD/P4A Angular contact ball bearings

Bearing No. 7222 ACD/P4A

Size	200x110x38 mm
Bore Diameter	200 mm
Outer Diameter	110 mm
Width	38 mm
d	110 mm
D	200 mm
B	38 mm
d ₁	138.7 mm
d ₂	138.7 mm
D ₁	171.3 mm
r _{1,2} - min.	2.1 mm
r _{3,4} - min.	1.1 mm
a	55.4 mm
d _a - min.	122 mm
d _b - min.	122 mm
D _a - max.	188 mm
D _b - max.	193 mm
r _a - max.	2 mm
r _b - max.	1 mm
d _n	145.9 mm
Basic dynamic load rating - C	168 kN
Basic static load rating - C ₀	160 kN
Fatigue load limit - P _u	5.4 kN
Limiting speed for grease	6700 r/min



BEARING USA CORP.

Lubrication	
Limiting speed for oil lubrication	10000 mm/min
Ball - D_w	26.988 mm
Ball - z	16
G_{ref}	54.15 cm ³
Calculation factor - e	0.68
Calculation factor - Y_2	0.87
Calculation factor - Y_0	0.38
Calculation factor - X_2	0.41
Calculation factor - Y_1	0.92
Calculation factor - Y_2	1.41
Calculation factor - Y_0	0.76
Calculation factor - X_2	0.67
Preload class A - G_A	1050 N
Preload class B - G_B	2100 N
Preload class C - G_C	4200 N
Preload class D - G_D	8400 N
Calculation factor - f	1.08
Calculation factor - f_1	0.99
Calculation factor - f_{2A}	1
Calculation factor - f_{2B}	1.01
Calculation factor - f_{2C}	1.02
Calculation factor - f_{2D}	1.05
Calculation factor - f_{HC}	1
Preload class A	325 N/micron
Preload class B	423 N/micron
Preload class C	557 N/micron
Preload class D	748 N/micron



BEARING USA CORP.

Category	Precision Ball Bearings
Inventory	0.0
Manufacturer Name	SKF
Minimum Buy Quantity	N/A
Weight / Kilogram	4.974
EAN	7316570610444
Product Group	B04270
Enclosure	Open
Precision Class	ABEC 7 ISO P4
Material - Ball	Steel
Number of Bearings	1 (Single)
Contact Angle	25 Degree
Preload	None
Raceway Style	1 Rib Outer Ring
Cage Material	Phenolic
Rolling Element	Ball Bearing
Flush Ground	No
Inch - Metric	Metric
Other Features	Single Row Angular Contact Super Precision High Capacity
Long Description	110MM Bore; 200MM Outside Diameter; 38MM Width; Open Enclosure; ABEC 7 ISO P4 Precision; Steel Ball Material; 1 (Single) Bearings; 25 Degree Contact Angle; Phenolic Cage Material; 1 Rib Outer Ring R
Category	Precision Ball Bearings
UNSPSC	31171531
Harmonized Tariff Code	8482.10.50.28
Noun	Bearing
Keyword String	Angular Contact Ball



BEARING USA CORP.

Manufacturer URL	http://www.skf.com
Manufacturer Item Number	7222 ACD/P4A
Weight / LBS	10.957
Width	1.496 Inch 38 Millimeter
Bore	4.331 Inch 110 Millimeter
Outside Diameter	7.874 Inch 200 Millimeter
d_1	138.7 mm
d_2	138.7 mm
D_1	171.3 mm
$r_{1,2}$ min.	2.1 mm
$r_{3,4}$ min.	1.1 mm
d_a min.	122 mm
d_b min.	122 mm
D_a max.	188 mm
D_b max.	193 mm
r_a max.	2 mm
r_b max.	1 mm
d_n	145.9 mm
Basic dynamic load rating C	168 kN
Basic static load rating C_0	160 kN
Fatigue load limit P_u	5.4 kN
Attainable speed for grease lubrication	6700 r/min
Attainable speed for oil-air lubrication	10000 r/min
Ball diameter D_w	26.988 mm
Number of balls z	16
Reference grease quantity G_{ref}	54.15 cm ³
Preload class A G_A	1050 N
Static axial stiffness, preload class A	325 N/ μ m
Preload class B G_B	2100 N



BEARING USA CORP.

Static axial stiffness, preload class B	423 N/ μ m
Preload class C G_C	4200 N
Static axial stiffness, preload class C	557 N/ μ m
Preload class D G_D	8400 N
Static axial stiffness, preload class D	748 N/ μ m
Calculation factor f	1.08
Calculation factor f_1	0.99
Calculation factor f_{2A}	1
Calculation factor f_{2B}	1.01
Calculation factor f_{2C}	1.02
Calculation factor f_{2D}	1.05
Calculation factor f_{HC}	1
Calculation factor e	0.68
Calculation factor (single, tandem) Y_2	0.87
Calculation factor (single, tandem) Y_0	0.38
Calculation factor (single, tandem) X_2	0.41
Calculation factor (back-to-back, face-to-face) Y_1	0.92
Calculation factor (back-to-back, face-to-face) Y_2	1.41
Calculation factor (back-to-back, face-to-face) Y_0	0.76
Calculation factor (back-to-back, face-to-face) X_2	0.67
Mass bearing	4.63 kg