

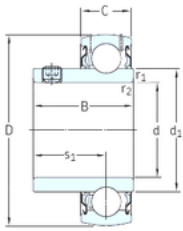

BEARING USA CORP.

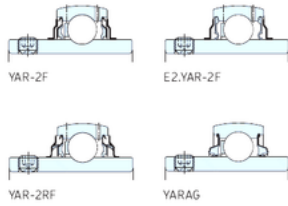

YAT



30 mm x 62 mm x 38,1 mm SKF E2.YAR206-2F
Deep groove ball bearings

Bearing No. E2.YAR206-2F

Size	30x62x38.1 mm
Bore Diameter	30 mm
Outer Diameter	62 mm
Width	38,1 mm
d	30 mm
D	62 mm
B	38,1 mm
C	18 mm
d1	39,7 mm
r1 min.	0,6 mm
r2 min.	0,6 mm
s1	22,2 mm
Weight	0,3 Kg
Basic dynamic load rating (C)	19,5 kN
Basic static load rating (C0)	11,2 kN
Fatigue load limit (Pu)	0,475

E2.YAR206-2F Bearing 2D drawings and 3D CAD models